

NIYAPARLI PEOPLE AND NIYAPARLI #3

DETERMINATION OF NATIVE TITLE

WAD 6280 of 1998 and WAD 196 of 2013

SCHEDULE TWO

LEGEND

- DETERMINATION AREA (Schedule One)
- EXCLUSIVE POSSESSION AREAS (paragraph 4 and Schedule Three)
- NON-EXCLUSIVE AREA (paragraph 5)
- AREAS WHERE NATIVE TITLE DOES NOT EXIST (paragraph 2 and Schedule Four)
- AREAS TO WHICH SECTIONS 47A OR 47B OF THE NTA APPLY - EXCLUSIVE AREA (paragraph 9 and Schedule Five)
- AREAS TO WHICH SECTION 47B OF THE NTA APPLIES - NON-EXCLUSIVE AREA (paragraph 9 and Schedule Five)

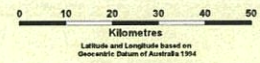

DATA SOURCES

Cadastral and Tenure information sourced from Landgate Spatial Cadastral Database (SCDB), 22 March 2016 and 27 February 2015. Administrative boundaries are sourced from the Landgate Administrative Boundaries Dataset. Topographical data sourced from the PRMA Dataset. Road names sourced from Landgate Road Centreline Dataset. Coastlines and shorelines are interpolated from aerial photography or recorded from ground surveys. Local Authorities terminate at Low Water Mark (LWM) unless otherwise specified. Pastoral Leases terminate 40 metres above High Water Mark (HWM) unless otherwise specified. Islands shown are Unincorporated Crown Land (UCL) unless otherwise specified. All referenced Deposited Plans and Diagrams are held by the Western Australian Land Information Authority, trading as Landgate. This map is indicative only.



DISCLAIMER

For informational purposes only, this map is a pictorial representation of data extracted from Landgate Datasets and is intended to be an overview of general geographical information. Waterlines shown on this map do not necessarily depict an exact cadastral boundary. Native title application boundaries interpolated from descriptions held by the National Native Title Tribunal (NNTT) and Federal Court. Reference should be made to the NNTT for confirmation of this boundary for any legal purposes. In the event of any discrepancy between the written application boundary description and the areas depicted on this map the written description shall take precedence as the maps and/or enlargements are indicative only.

GRAPHIC SERVICES
 PRODUCED 25/07/2018

Street address: 1 Midland Square, Midland, WA 6005
 Postal address: PO Box 2222, Midland, WA 6005
 Tel: (08) 9273 7301 Fax: (08) 9273 7816
 email: rhes@landgate.wa.gov.au
 Internet: www.landgate.wa.gov.au

© Western Australian Land Information Authority 2018

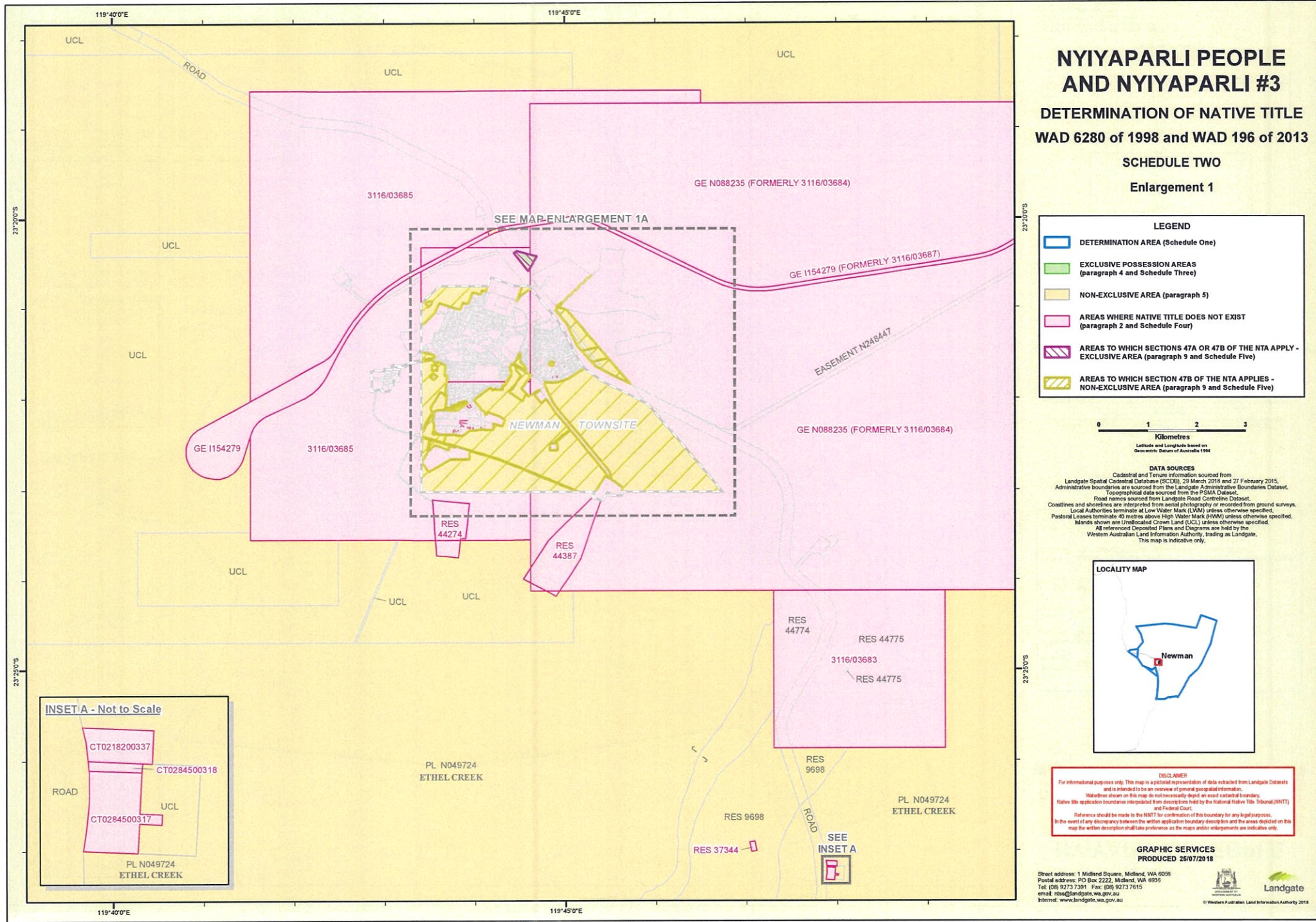

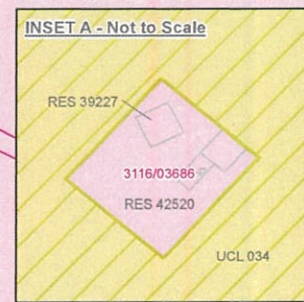
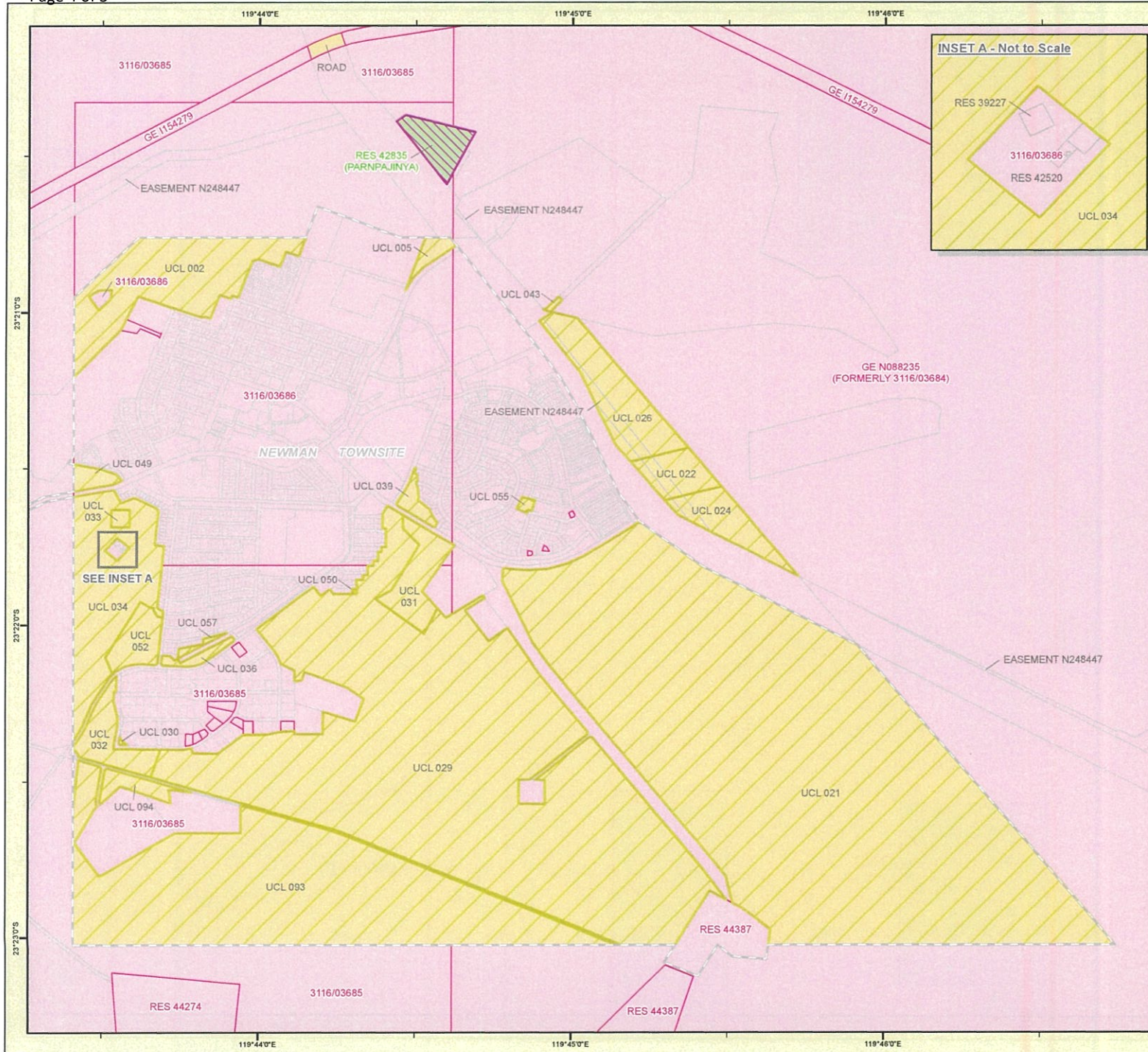

NYIYAPARLI PEOPLE AND NYIYAPARLI #3

DETERMINATION OF NATIVE TITLE WAD 6280 of 1998 and WAD 196 of 2013

SCHEDULE TWO Enlargement 1A

- LEGEND**
- DETERMINATION AREA (Schedule One)
 - EXCLUSIVE POSSESSION AREAS (paragraph 4 and Schedule Three)
 - NON-EXCLUSIVE AREA (paragraph 5)
 - AREAS WHERE NATIVE TITLE DOES NOT EXIST (paragraph 2 and Schedule Four)
 - AREAS TO WHICH SECTIONS 47A OR 47B OF THE NTA APPLY - EXCLUSIVE AREA (paragraph 9 and Schedule Five)
 - AREAS TO WHICH SECTION 47B OF THE NTA APPLIES - NON-EXCLUSIVE AREA (paragraph 9 and Schedule Five)



DATA SOURCES
 Cadastral and Tenure information sourced from Landgate Spatial Cadastral Database (SCDB), 20 March 2016 and 27 February 2015.
 Administrative boundaries are sourced from the Landgate Administrative Boundaries Dataset.
 Topographical data sourced from the PIMA Dataset.
 Road names sourced from Landgate Road Centreline Dataset.
 Coastlines and shorelines are interpreted from aerial photography or recorded from ground surveys.
 Local Authorities terminate at Low Water Mark (LWM) unless otherwise specified.
 Pastoral Leases terminate 40 metres above High Water Mark (HWM) unless otherwise specified.
 Islands shown are Unallocated Crown Land (UCL) unless otherwise specified.
 All referenced Deposited Plans and Diagrams are held by the Western Australian Land Information Authority, trading as Landgate.
 This map is indicative only.



DISCLAIMER
 For informational purposes only. This map is a pictorial representation of data extracted from Landgate Datasets and is intended to be an overview of general geographical information.
 Boundaries shown on this map do not necessarily depict an exact cadastral boundary.
 Native title application boundaries interpolated from descriptions held by the National Native Title Tribunal (NNTT) and Federal Court.
 Reference should be made to the NNTT for confirmation of this boundary for any legal purposes.
 In the event of any discrepancy between the written application boundary description and the areas depicted on this map the written description shall take precedence over the maps and/or enlargements are indicative only.

**GRAPHIC SERVICES
PRODUCED 25/07/2018**

Street address: 1 Midland Square, Midland, WA 6055
 Postal address: PO Box 2222, Midland, WA 6056
 Tel: (08) 9273 7301 Fax: (08) 9273 7615
 email: rhes@landgate.wa.gov.au
 Internet: www.landgate.wa.gov.au



© Western Australian Land Information Authority 2018

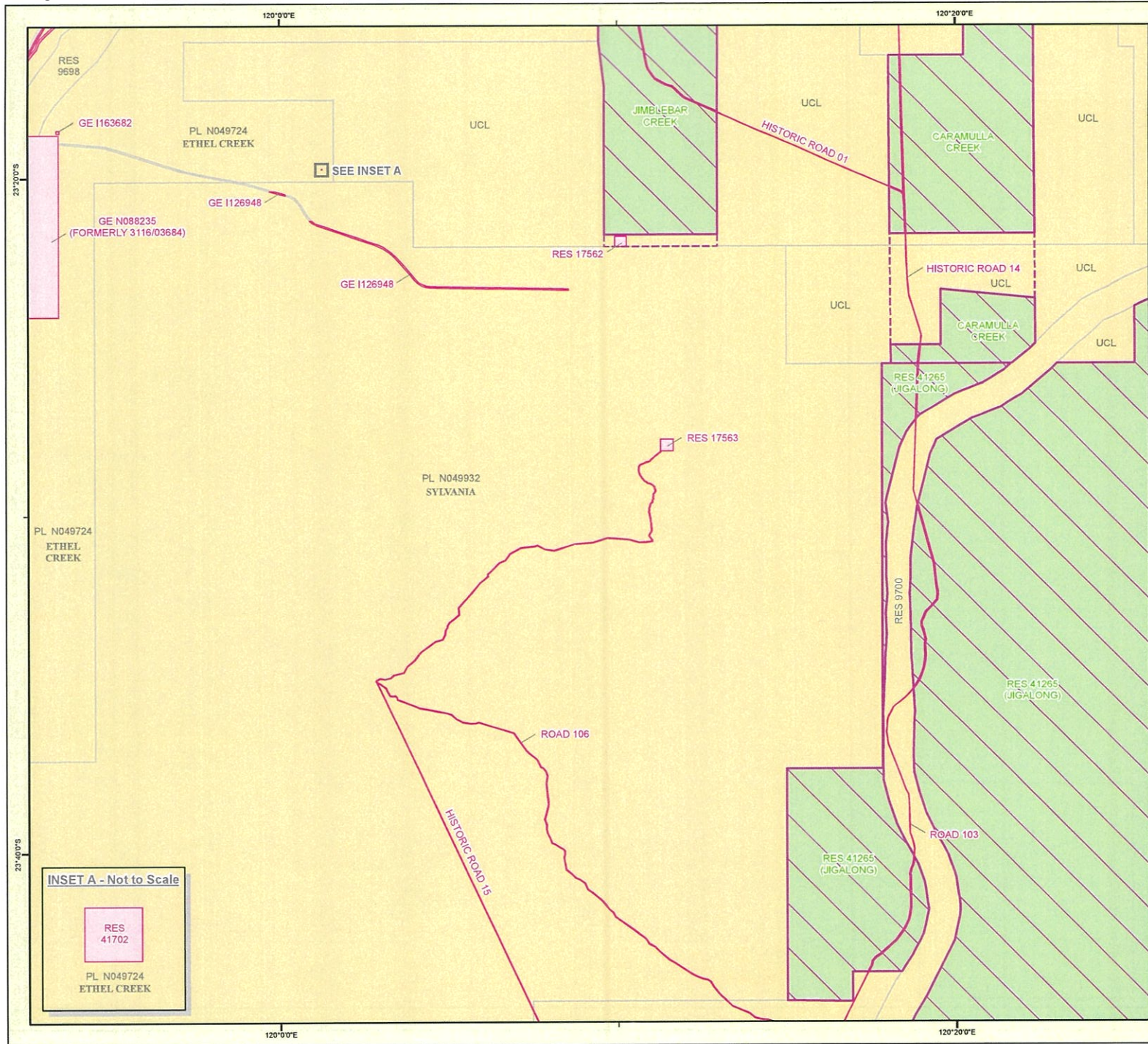

NYIYAPARLI PEOPLE AND NYIYAPARLI #3

DETERMINATION OF NATIVE TITLE WAD 6280 of 1998 and WAD 196 of 2013

SCHEDULE TWO Enlargement 2

LEGEND

- DETERMINATION AREA (Schedule One)
- EXCLUSIVE POSSESSION AREAS (paragraph 4 and Schedule Three)
- NON-EXCLUSIVE AREA (paragraph 5)
- AREAS WHERE NATIVE TITLE DOES NOT EXIST (paragraph 2 and Schedule Four)
- AREAS TO WHICH SECTIONS 47A OR 47B OF THE NTA APPLY - EXCLUSIVE AREA (paragraph 9 and Schedule Five)
- AREAS TO WHICH SECTION 47B OF THE NTA APPLIES - NON-EXCLUSIVE AREA (paragraph 9 and Schedule Five)

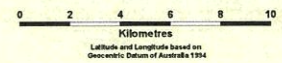

DATA SOURCES

Cadastral and Tenure information sourced from Landgate Spatial Cadastral Database (SCDB), 29 March 2016 and 27 February 2015.
 Administrative boundaries are sourced from the Landgate Administrative Boundaries Dataset.
 Topographical data sourced from the PSMA Dataset.
 Road names sourced from Landgate Road Centreline Dataset.
 Coastlines and shorelines are interpreted from aerial photography or recorded from ground surveys.
 Local Authorities terminate at Low Water Mark (LWM) unless otherwise specified.
 Pastoral Leases terminate 40 metres above High Water Mark (HWM) unless otherwise specified.
 Islands shown are Unallocated Crown Land (UCL) unless otherwise specified.
 All referenced Deposited Plans and Diagrams are held by the Western Australian Land Information Authority, trading as Landgate.
 This map is indicative only.

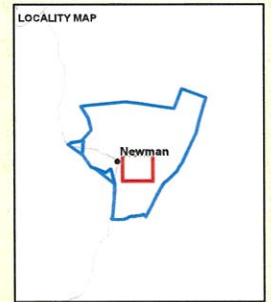

DISCLAIMER

For informational purposes only. This map is a pictorial representation of data extracted from Landgate Datasets and is intended to be an overview of general geographical information.
 Boundaries shown on this map do not necessarily depict an exact cadastral boundary.
 Native title application boundaries interpolated from descriptions held by the National Native Title Tribunal (NNTT) and Federal Court.
 Reference should be made to the NNTT for confirmation of this boundary for any legal purposes.
 In the event of any discrepancy between the written application boundary description and the areas depicted on this map the written description shall take precedence over the map and/or interpretations are indicative only.

**GRAPHIC SERVICES
PRODUCED 25/07/2018**

Street address: 1 Midland Square, Midland, WA 6056
 Postal address: PO Box 2222, Midland, WA 6056
 Tel: (08) 9273 7301 Fax: (08) 9273 7675
 email: rts@landgate.wa.gov.au
 Internet: www.landgate.wa.gov.au



© Western Australian Land Information Authority 2018

INSET A - Not to Scale

RES 41702
 PL N049724
 ETHEL CREEK